

HOLE PUNCHING MACHINE Type FST-H2



- The machine FST-H2 punches simultaneously five hole in the partitions of polypropylene monoblocs.
- The position of the punching heads is adjustable in order to punch different type of batteries.
- The correct location and alignment of the punching heads is obtained by using shaped plates (each plate for each type of battery). It also guides the container when it is inserted into the machine.
- The punches are interchangeable and can be supplied according to the customer request.
- To reduce the time to change the tools the machine is equipped with double set of heads for truck and cars batteries assembled on the same die holder.
- Available version with single set of heads (FST-H1).
- An hydraulic unit powered the machine.



Sample of punching set 6x1 for car batteries.

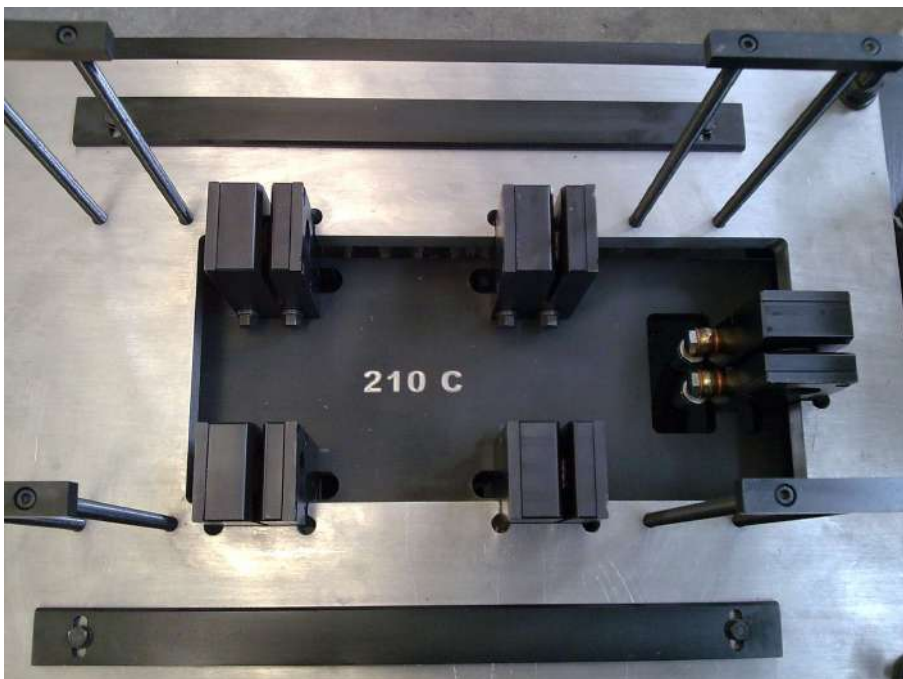

Sample of punching set 3x2 for truck batteries.



Position of the monoblocs to punch.



Hydraulic unit.

DOUBLE SET OF PUNCHING (FST-H2)

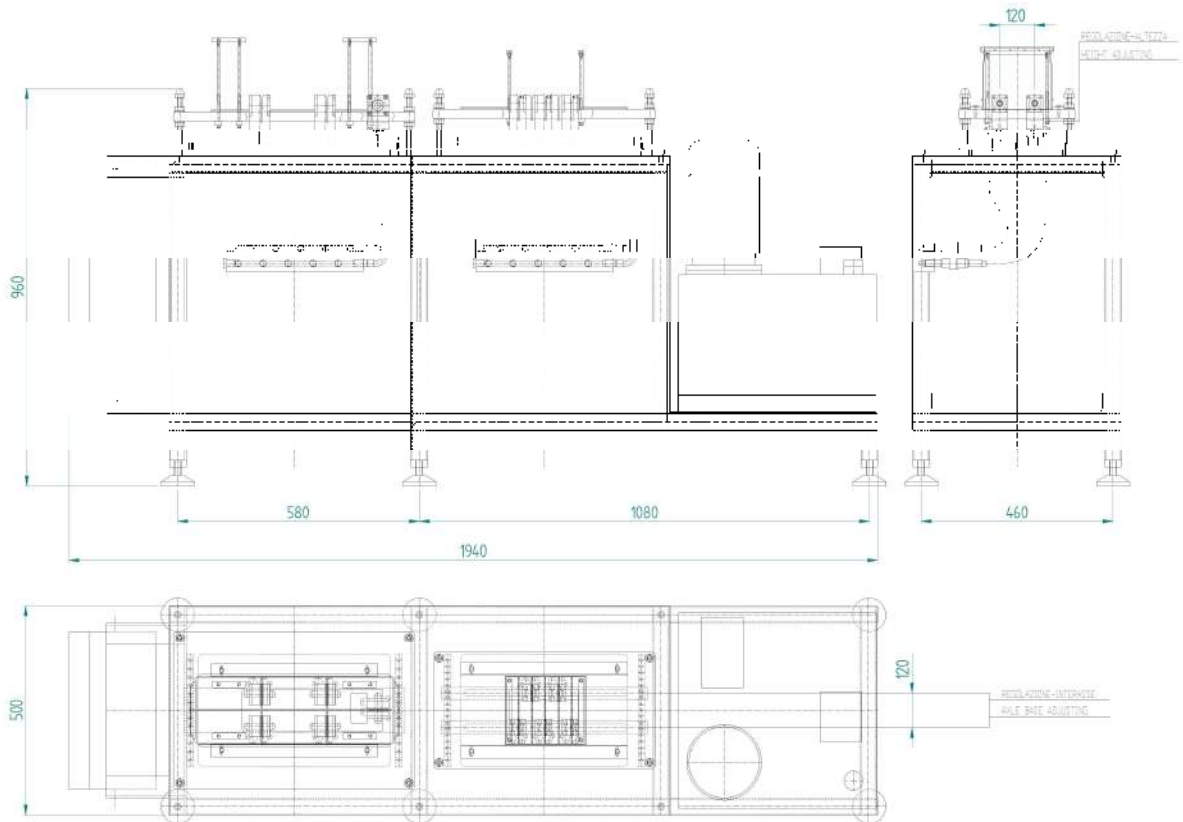

TECHNICAL DATA

- Overall Dimensions: **mm 1940x500x960h**
- Weight: **280 Kg**
- Electricity: **380 V – 50 Hz**
- Installed Power: **1Kw**
- Working Pressure: **45 – 50 bar**
- Box Capacity: **all PP DIN boxes for truck and car batteries**
- Cycle Time: **1 container each 6 sec.**

SINGLE SET OF PUNCHING (FST-H1)



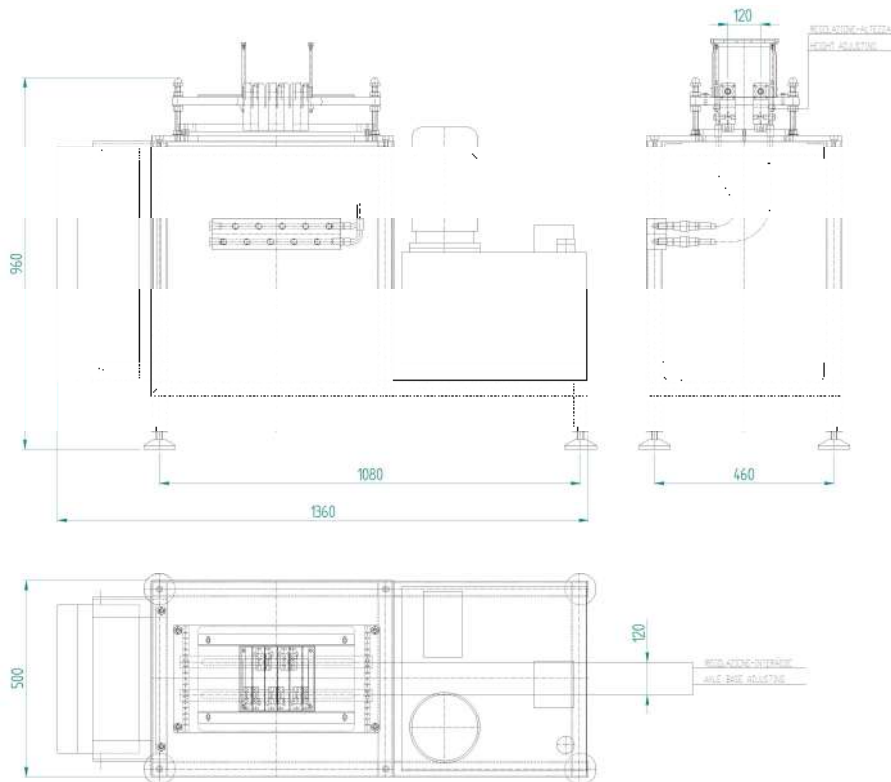

TECHNICAL DATA

- Overall Dimensions: **mm 1360x500x960h**
- Weight: **280 Kg**
- Electricity: **380 V – 50 Hz**
- Installed Power: **1Kw**
- Working Pressure: **45 – 50 bar**
- Box Capacity: **all PP DIN boxes for truck and car batteries**
- Cycle Time: **1 container each 6 sec.**

WE RESERVE ANY POSSIBLE MODIFICATIONS